

# THE ALTMAN BUILDING

New York

## Conference w/Standard Stage



# THE ALTMAN BUILDING

New York

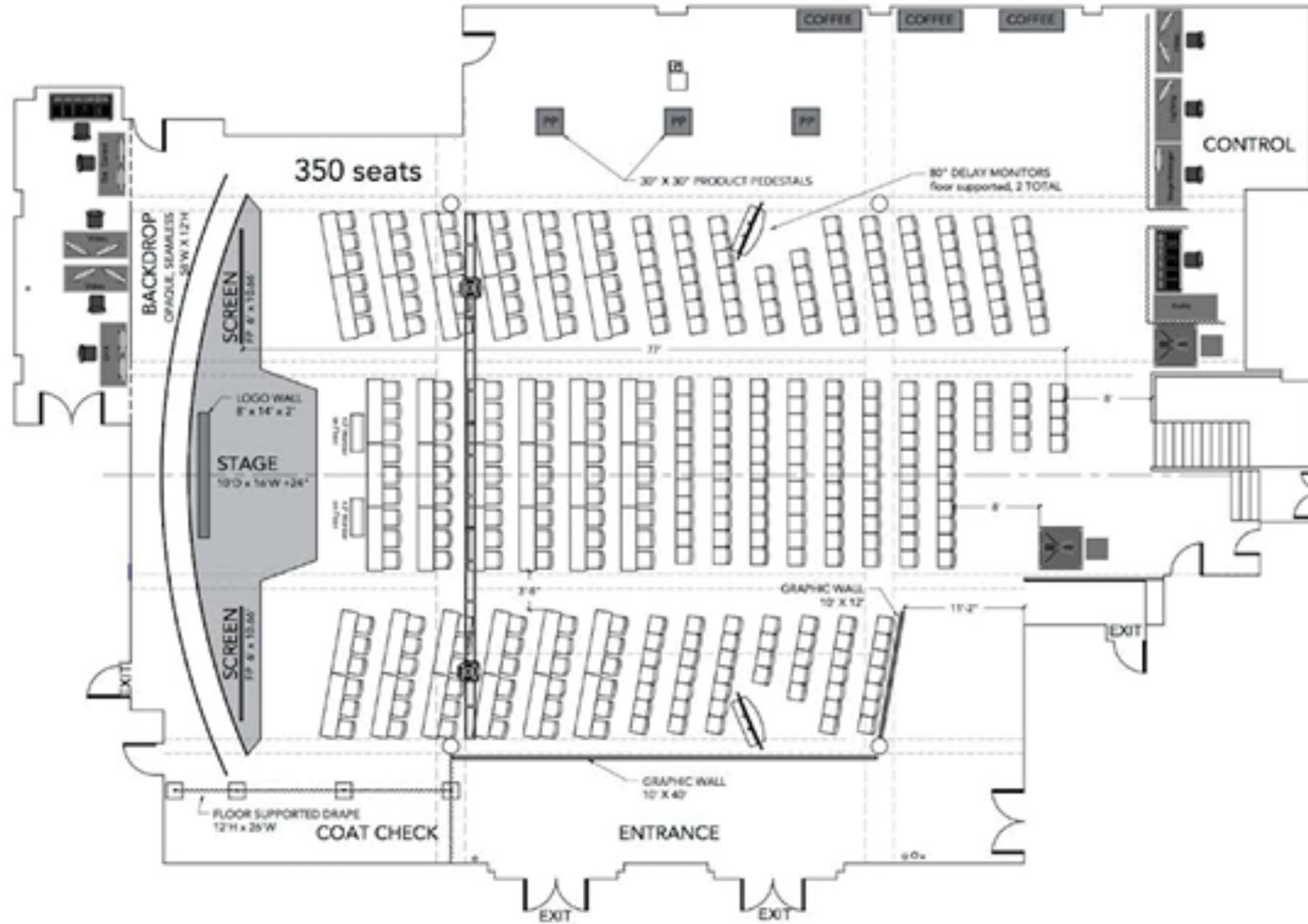

# THE ALTMAN BUILDING

New York

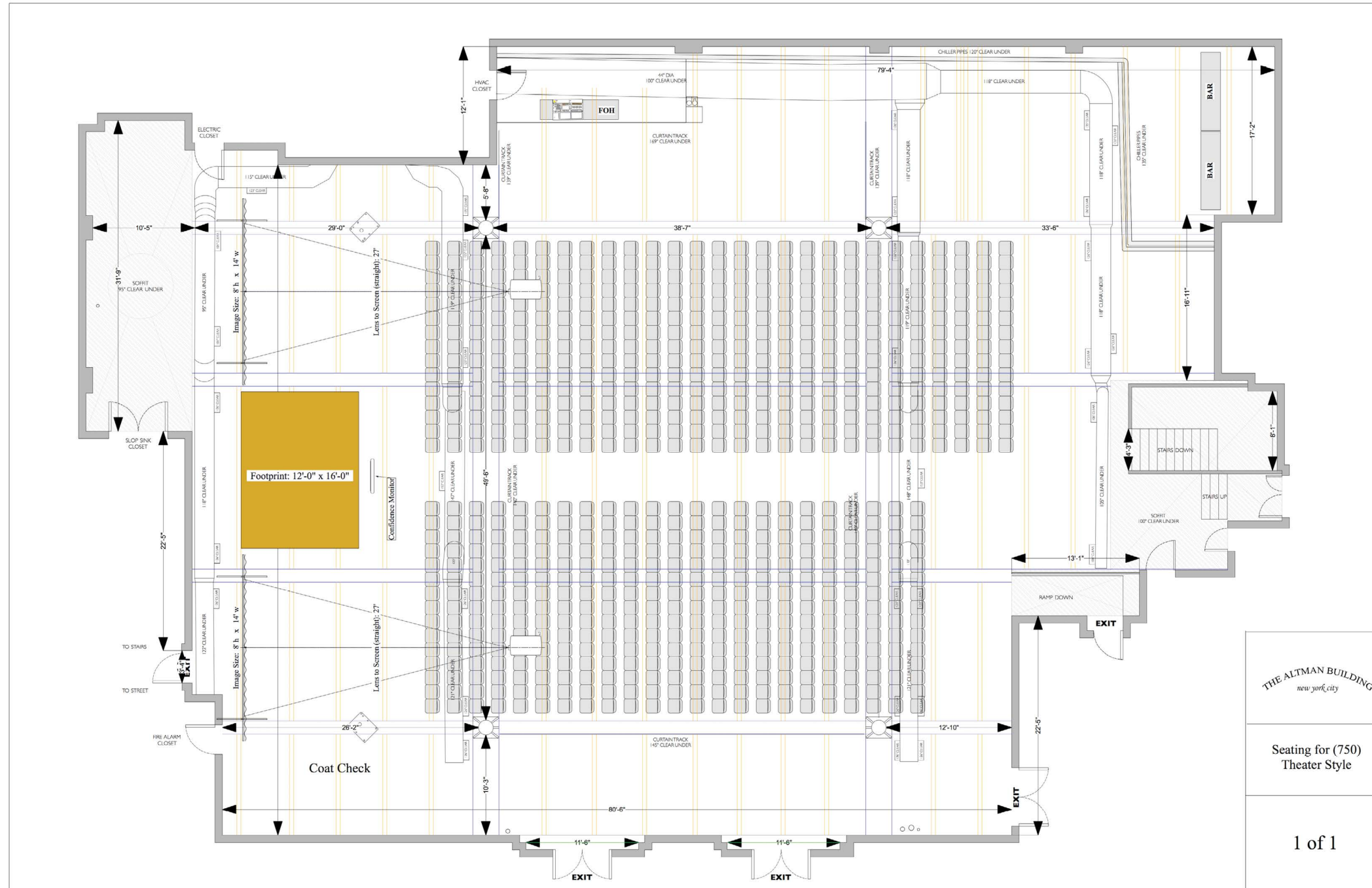

THE ALTMAN BUILDING  
new york city

Seating for (750)  
Theater Style

1 of 1

# THE ALTMAN BUILDING

New York

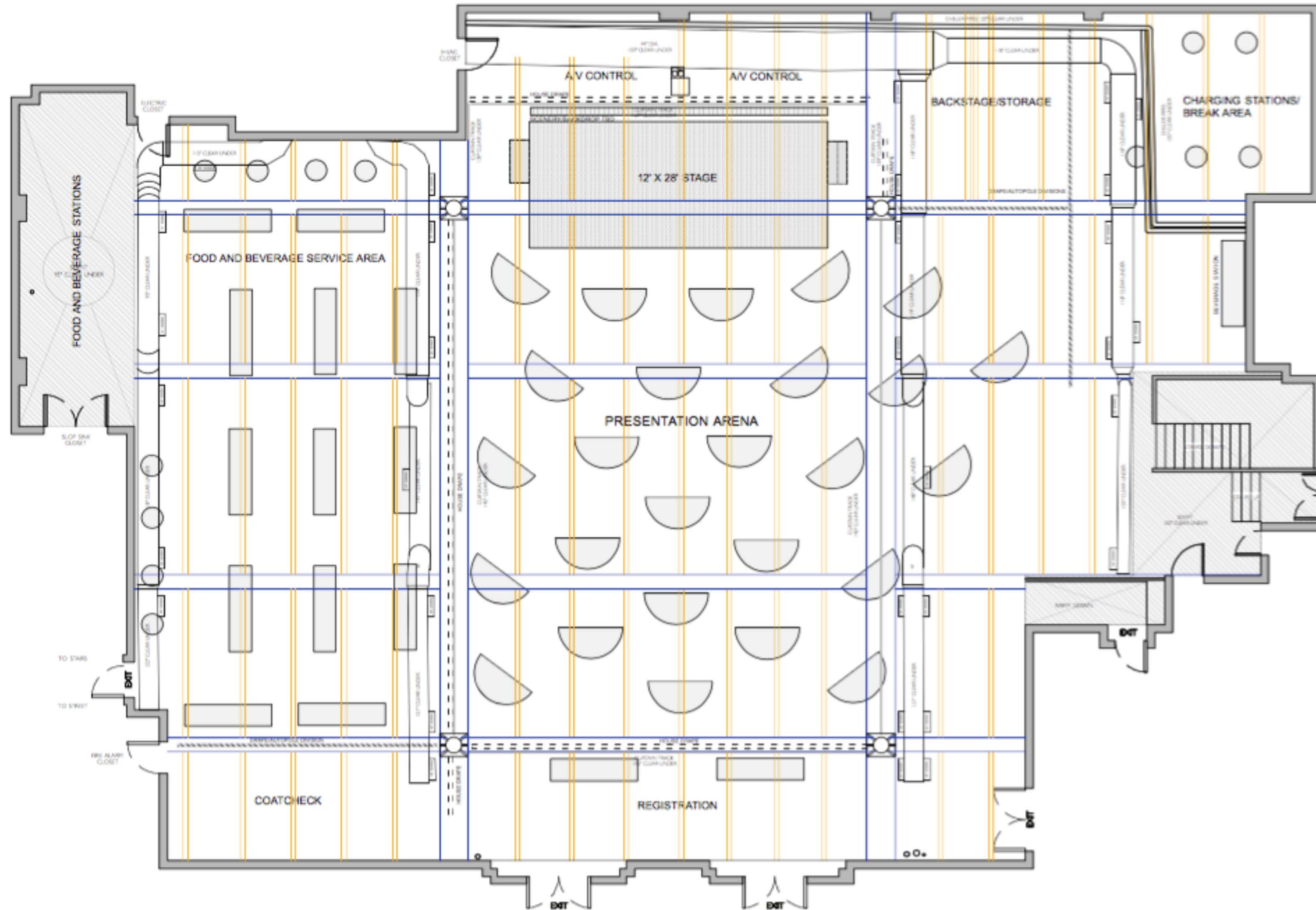

# THE ALTMAN BUILDING

New York

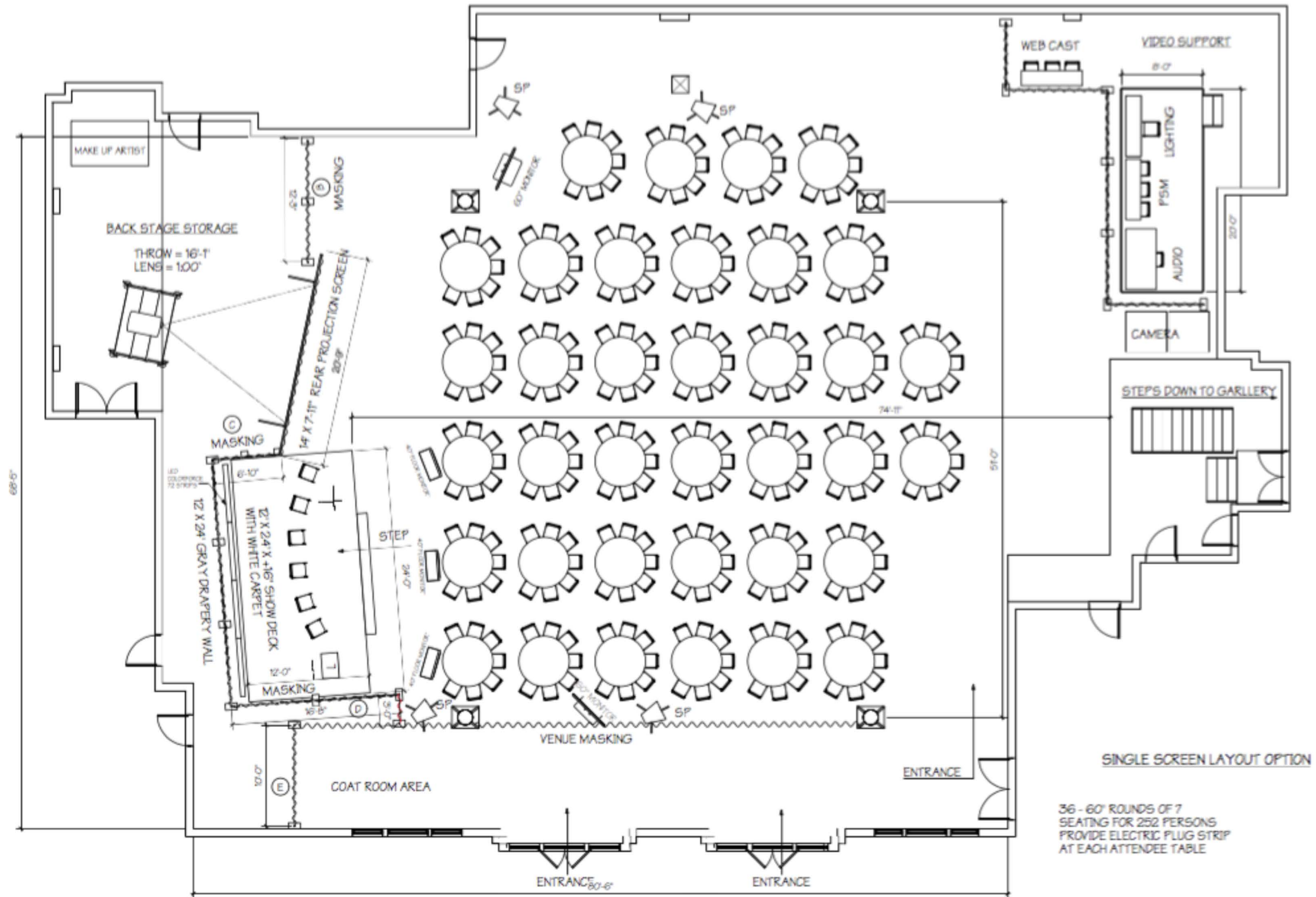

# THE ALTMAN BUILDING

New York

## Award Show

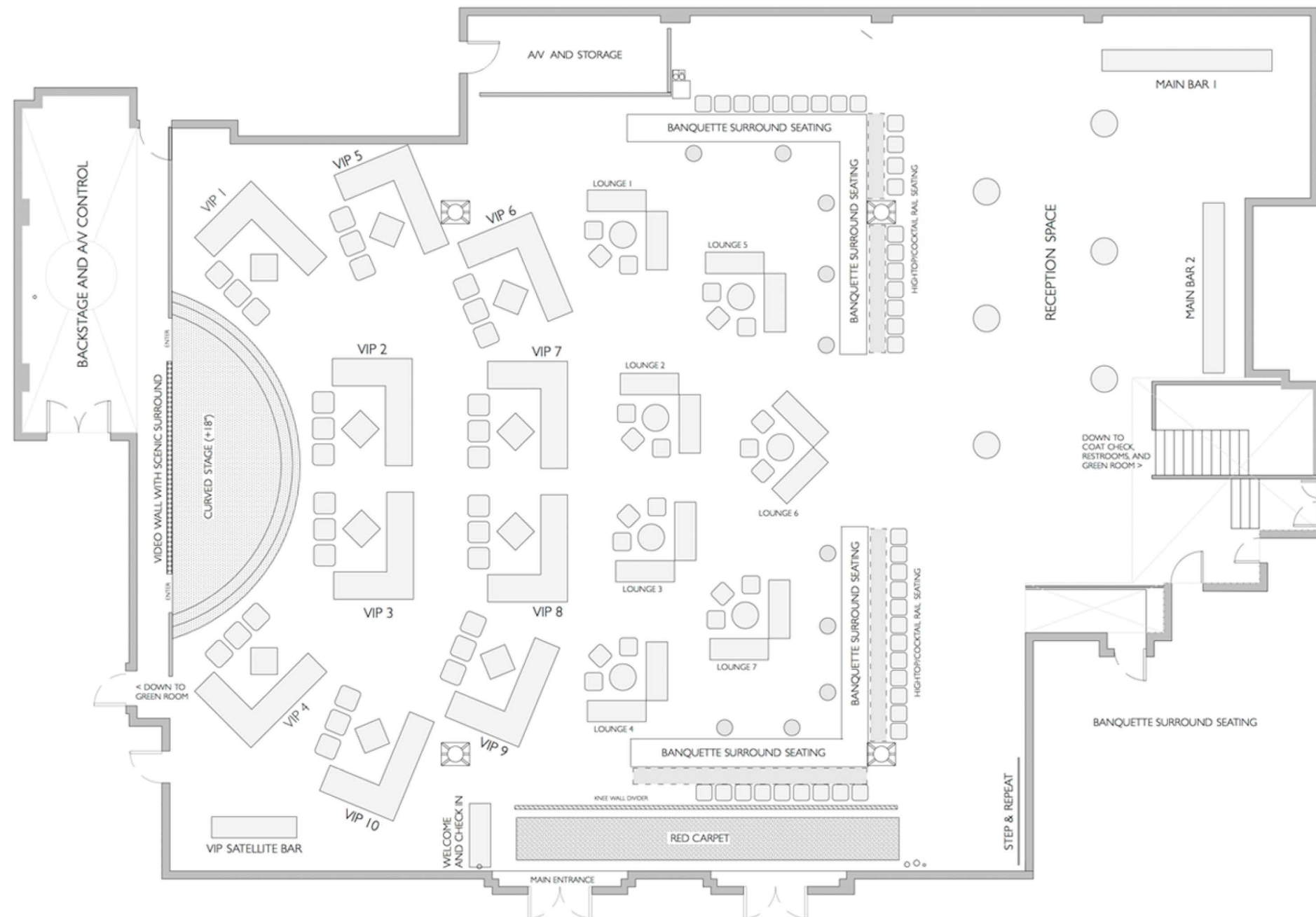

# THE ALTMAN BUILDING

New York

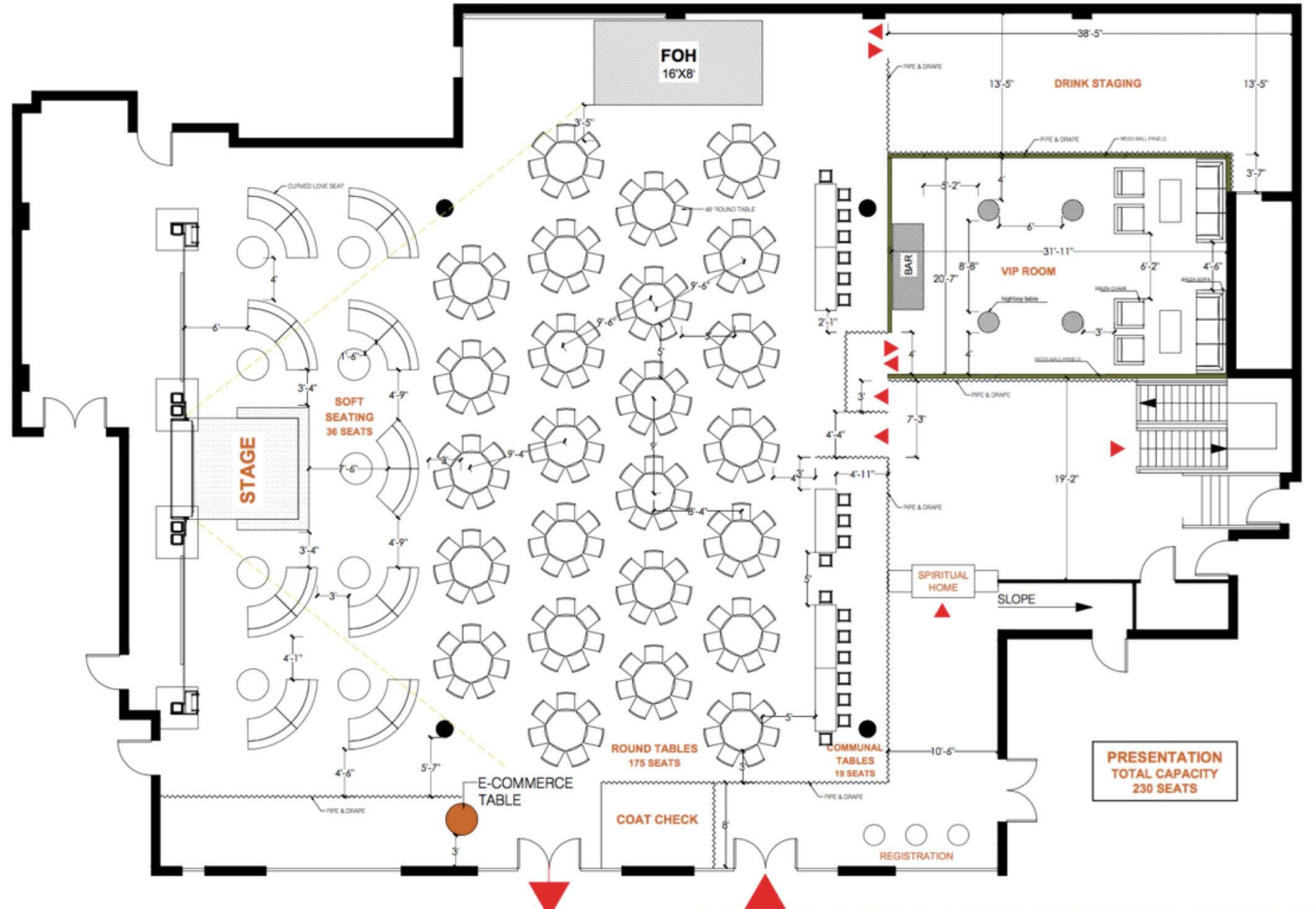

# THE ALTMAN BUILDING

New York

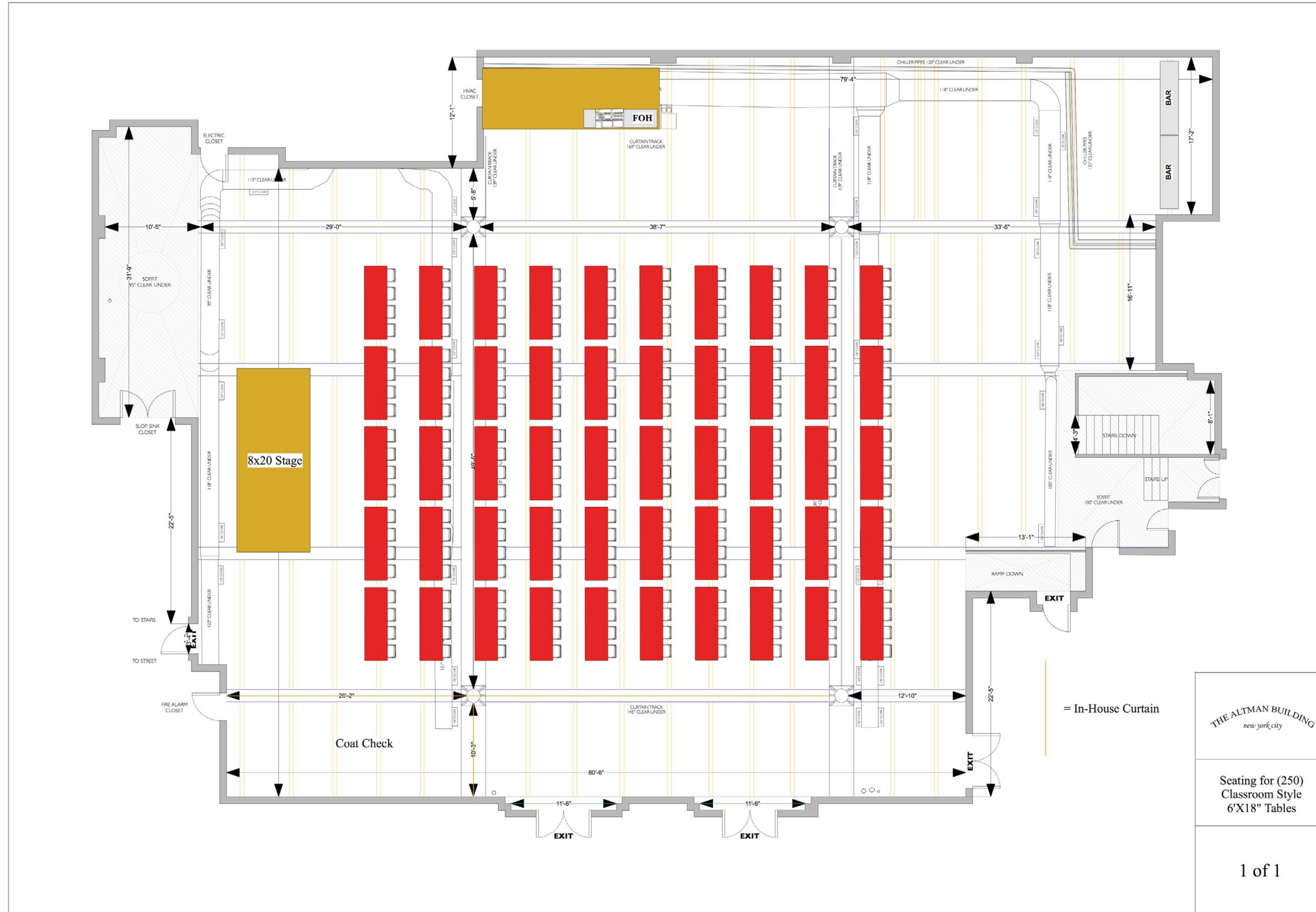

THE ALTMAN BUILDING  
new york city

Seating for (250)  
Classroom Style  
6'X18" Tables

1 of 1



# THE ALTMAN BUILDING

New York

## Automotive Show

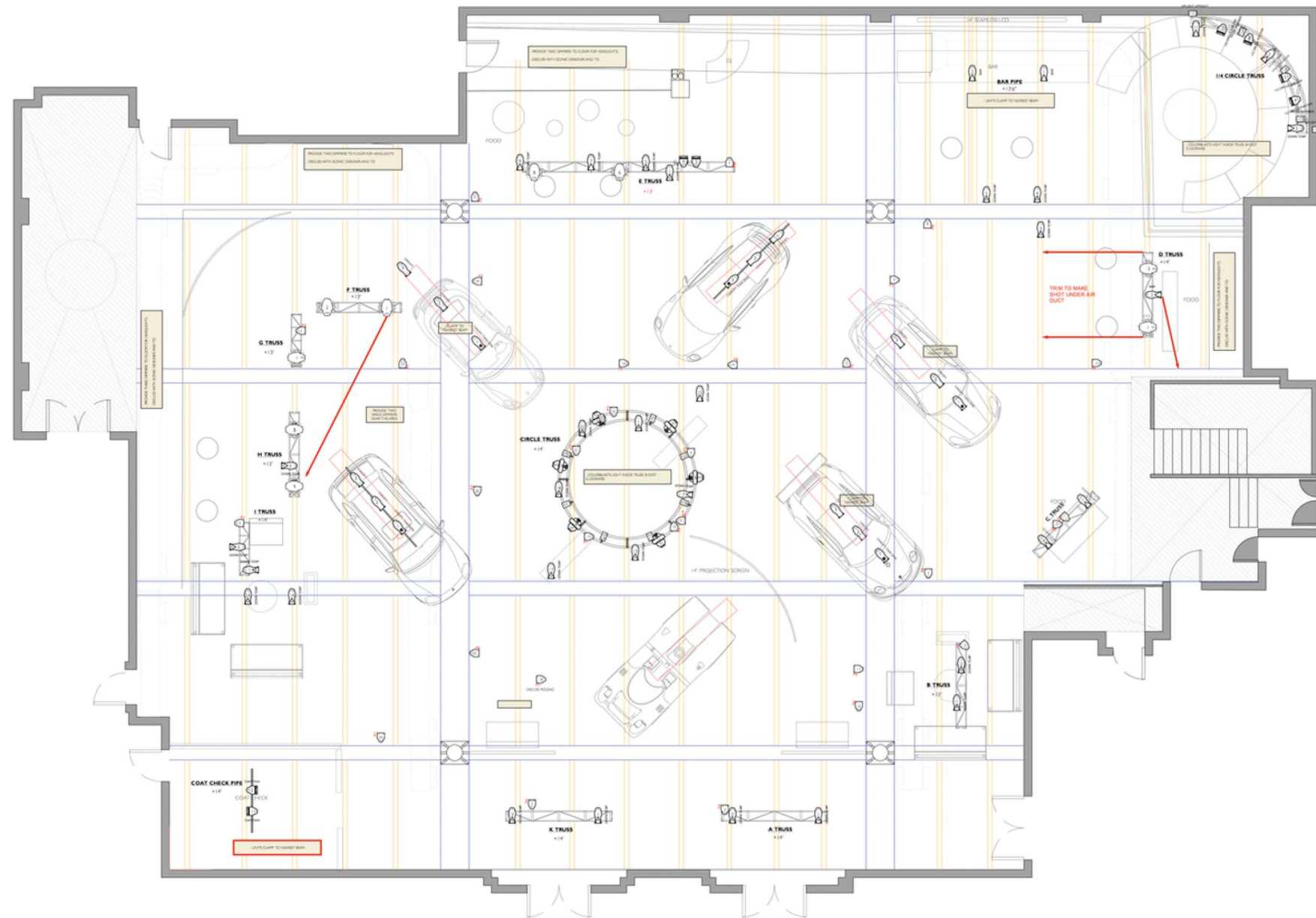

# THE ALTMAN BUILDING

New York

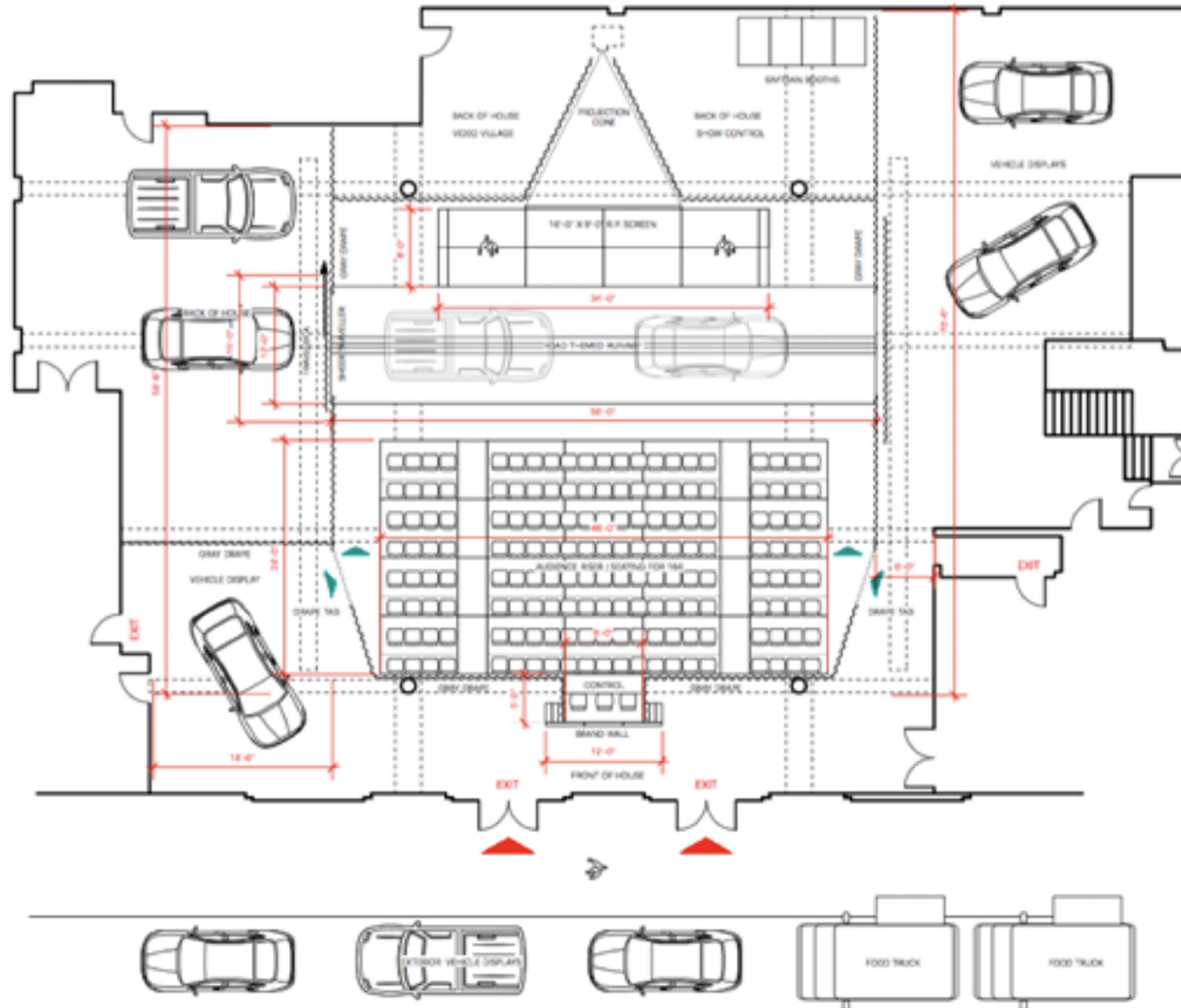

# THE ALTMAN BUILDING

New York

## Fashion Show

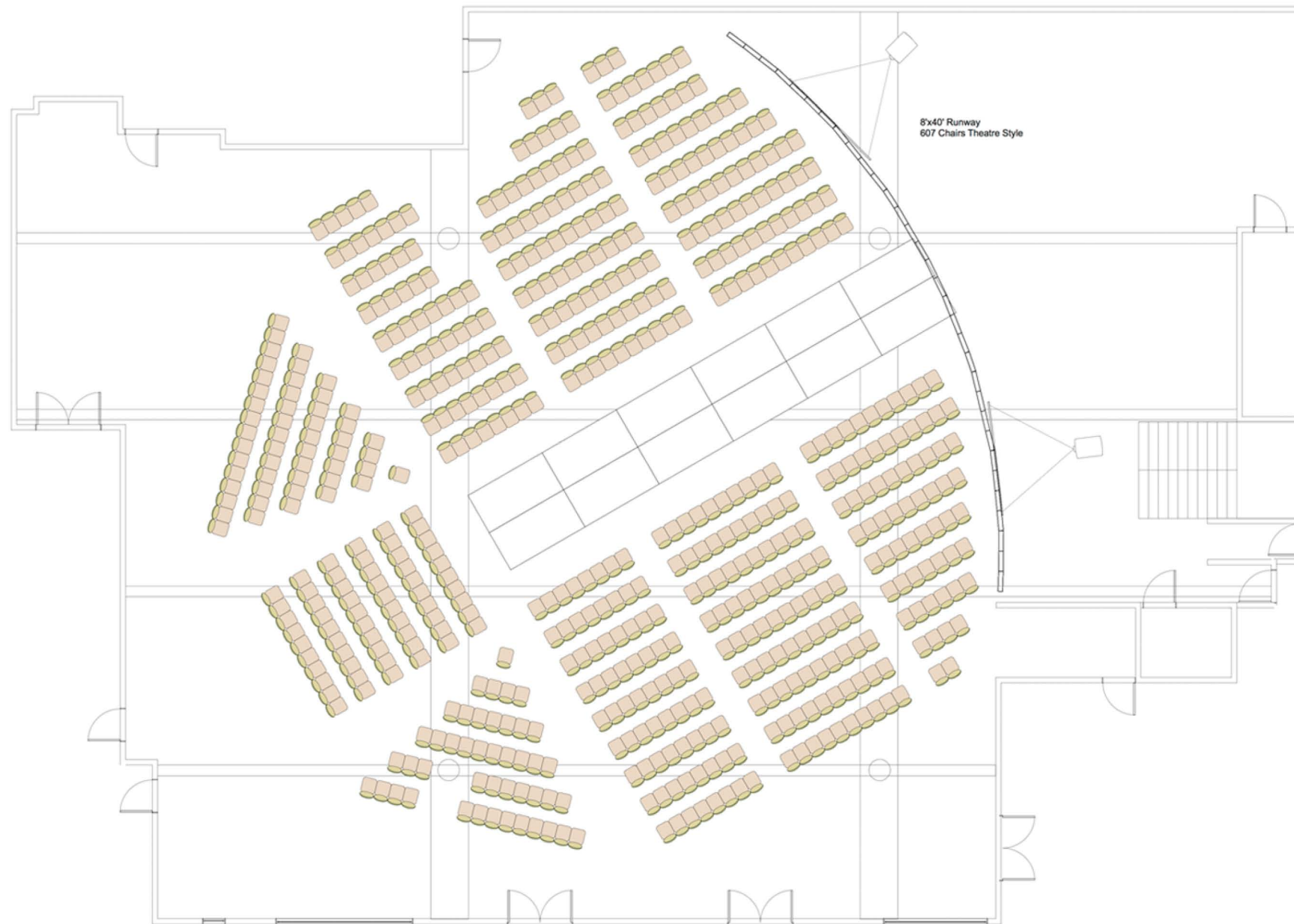

# THE ALTMAN BUILDING

New York

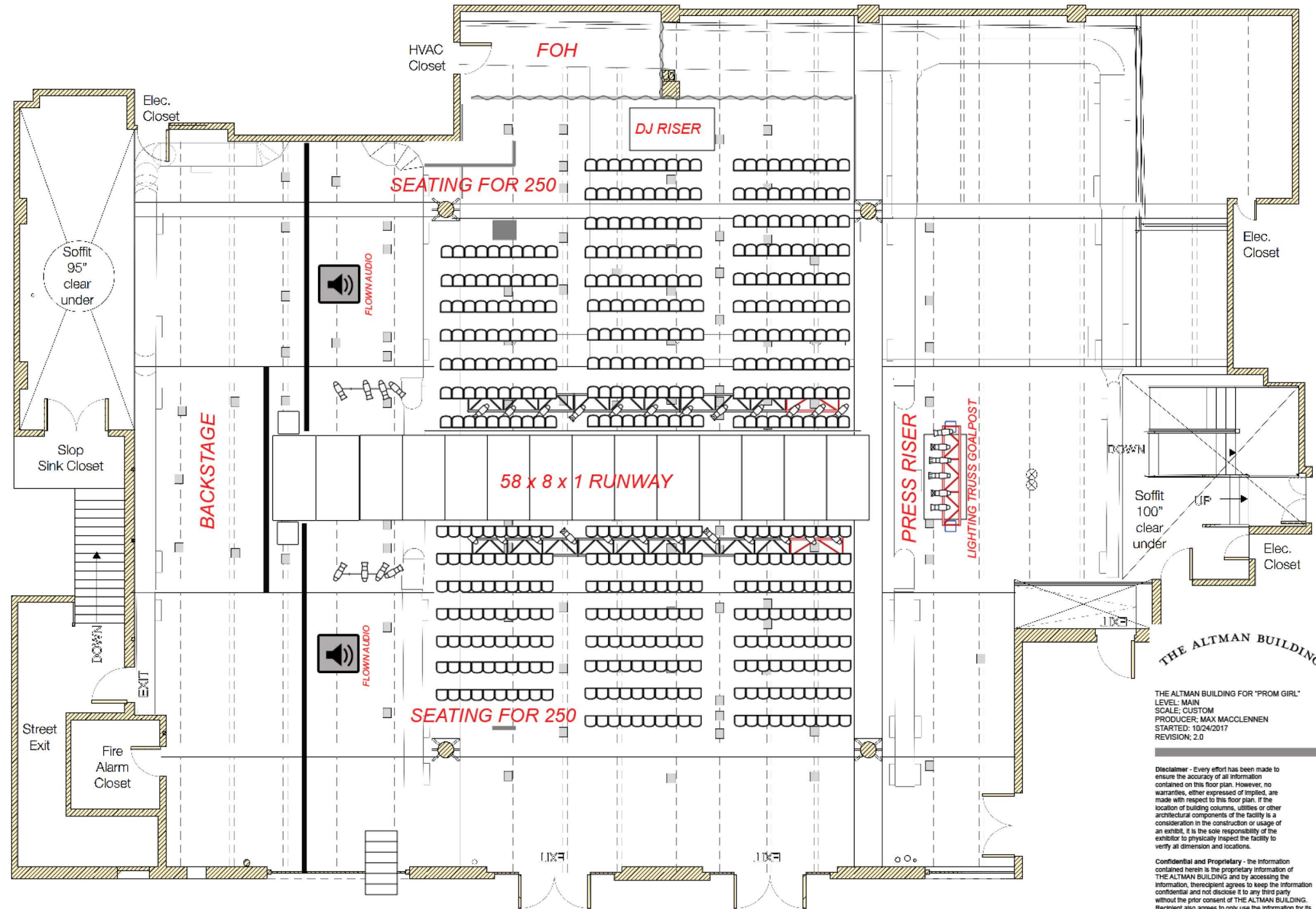

THE ALTMAN BUILDING

THE ALTMAN BUILDING FOR "PROM GIRL"  
 LEVEL: MAIN  
 SCALE: CUSTOM  
 PRODUCER: MAX MACCLENNEN  
 STARTED: 10/24/2017  
 REVISION: 2.0

**Disclaimer -** Every effort has been made to ensure the accuracy of all information contained on this floor plan. However, no warranties, either expressed or implied, are made with respect to this floor plan. If the location of building columns, utilities or other architectural components of the facility is a consideration in the construction or usage of an exhibit, it is the sole responsibility of the exhibitor to physically inspect the facility to verify all dimension and locations.

**Confidential and Proprietary -** The information contained herein is the proprietary information of THE ALTMAN BUILDING and by accessing the information, the recipient agrees to keep the information confidential and not disclose it to any third party without the prior consent of THE ALTMAN BUILDING. Recipient also agrees to only use the information for its internal evaluation purposes and for no other purpose, without the prior consent of THE ALTMAN BUILDING.

# THE ALTMAN BUILDING

New York

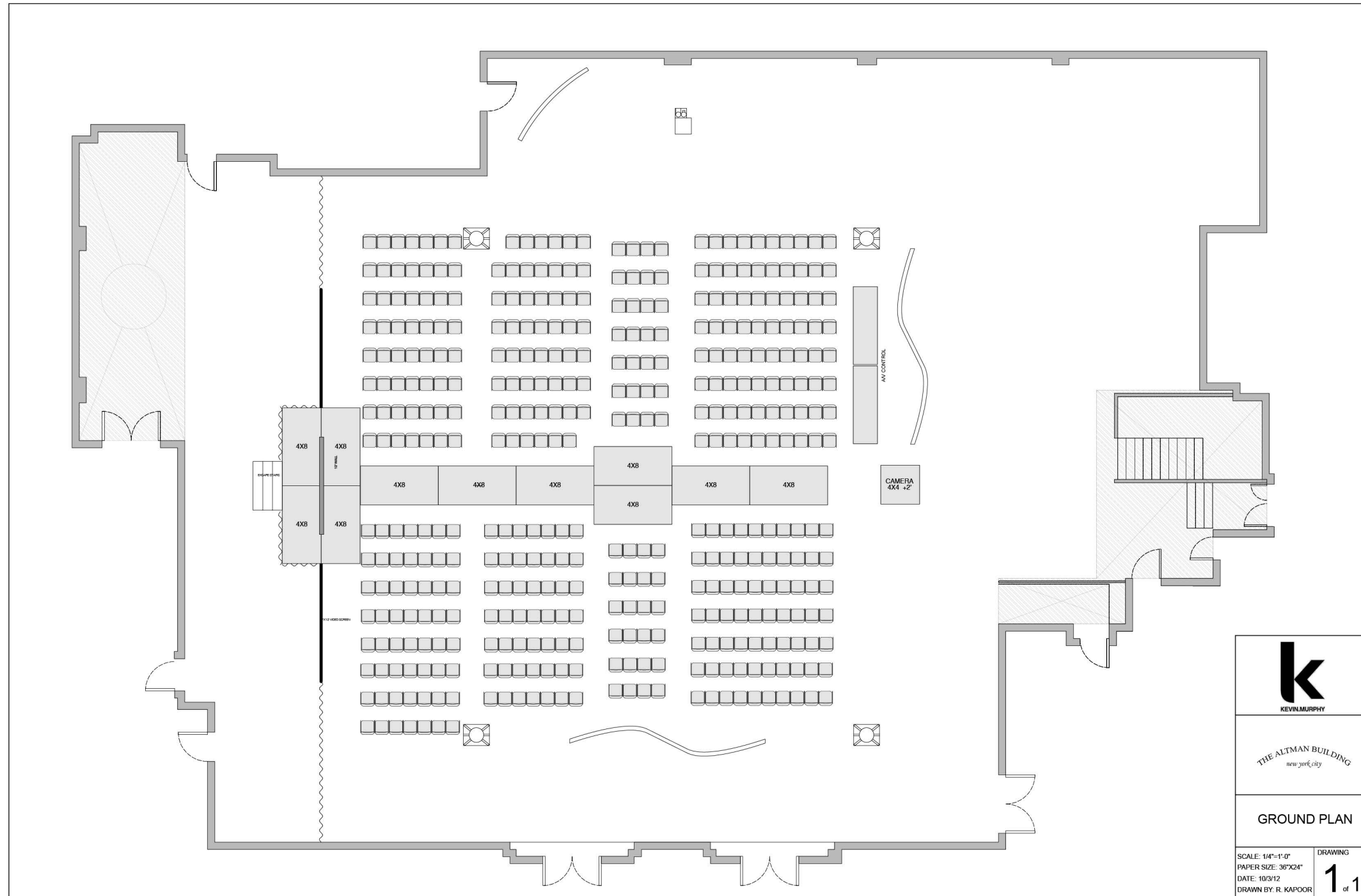

 KEVINMURPHY	
THE ALTMAN BUILDING new york city	
GROUND PLAN	
SCALE: 1/4"=1'-0" PAPER SIZE: 36"X24" DATE: 10/3/12 DRAWN BY: R. KAPOOR	DRAWING <b>1</b> of 1

# THE ALTMAN BUILDING

New York

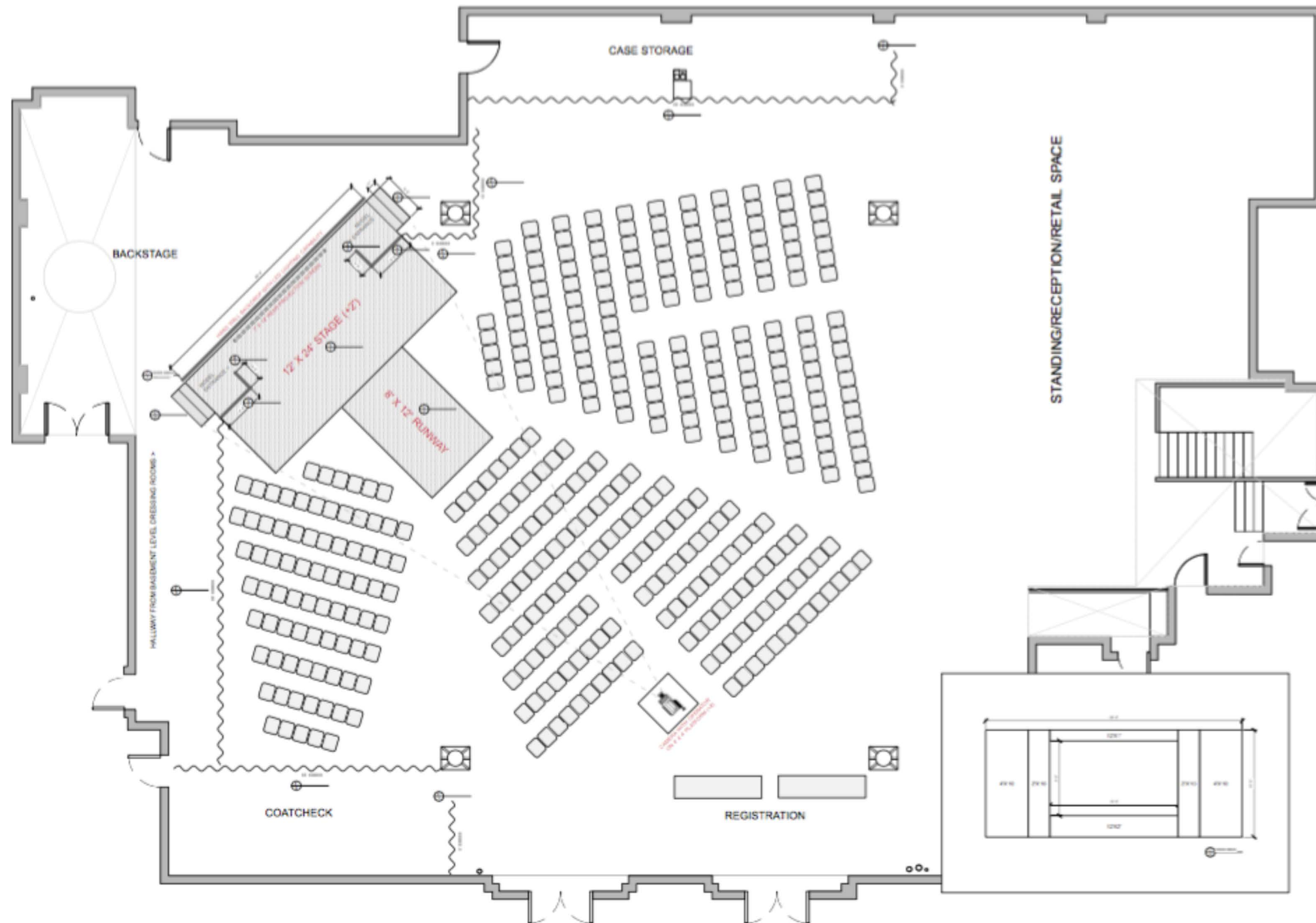

# THE ALTMAN BUILDING

New York

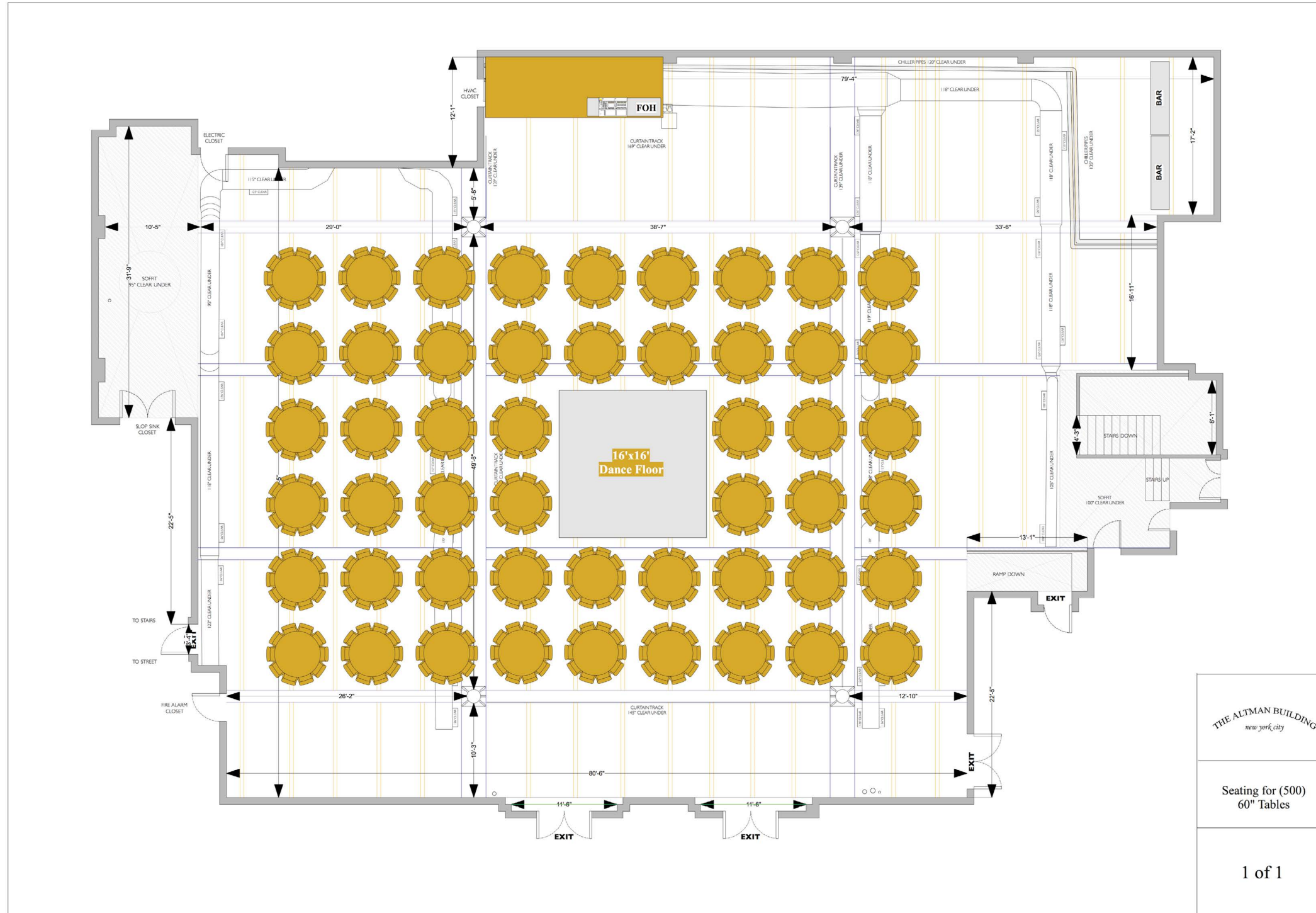

THE ALTMAN BUILDING  
new york city

Seating for (500)  
60" Tables

1 of 1

# THE ALTMAN BUILDING

New York

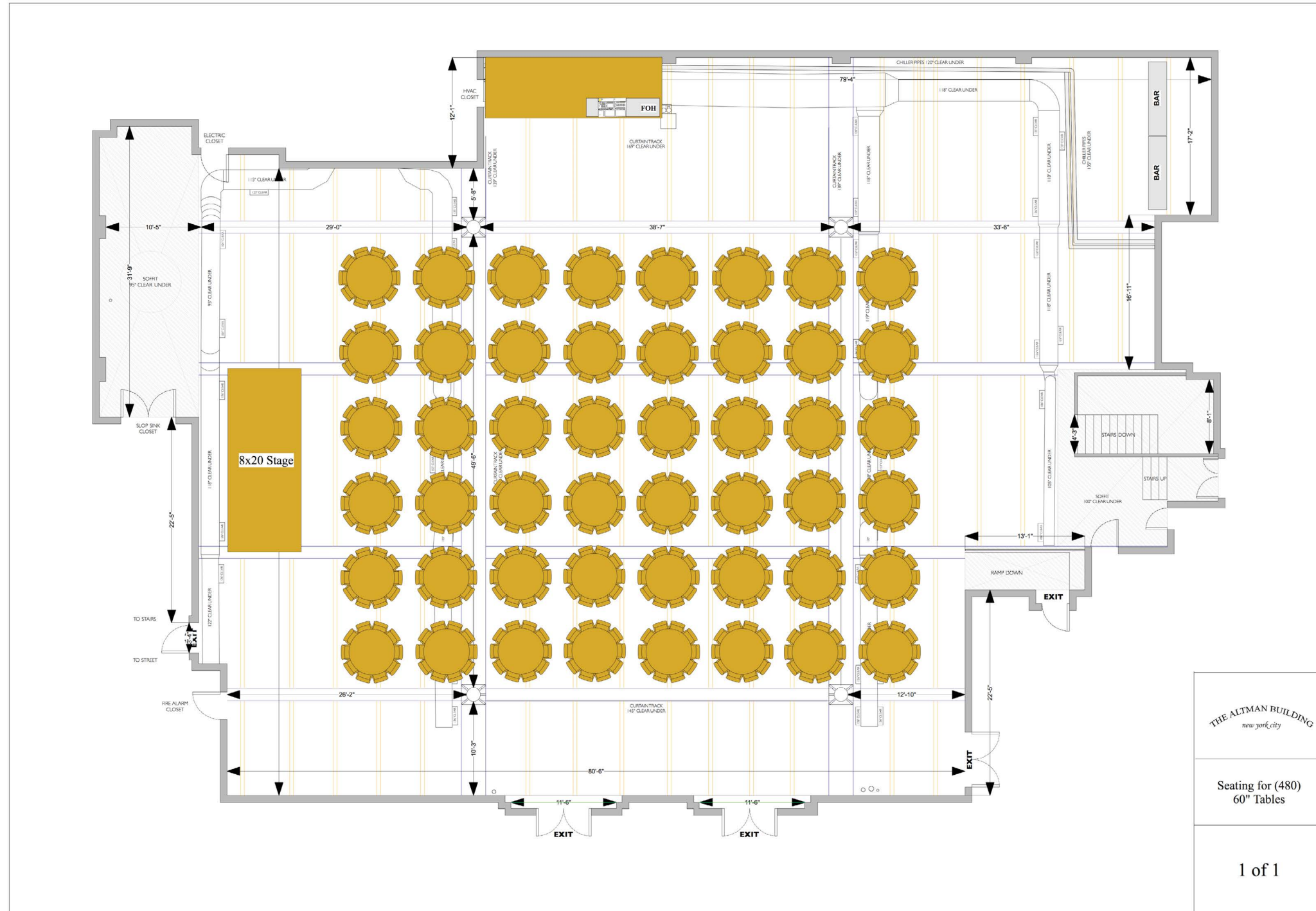

THE ALTMAN BUILDING  
new york city

Seating for (480)  
60" Tables

1 of 1



# THE ALTMAN BUILDING

New York

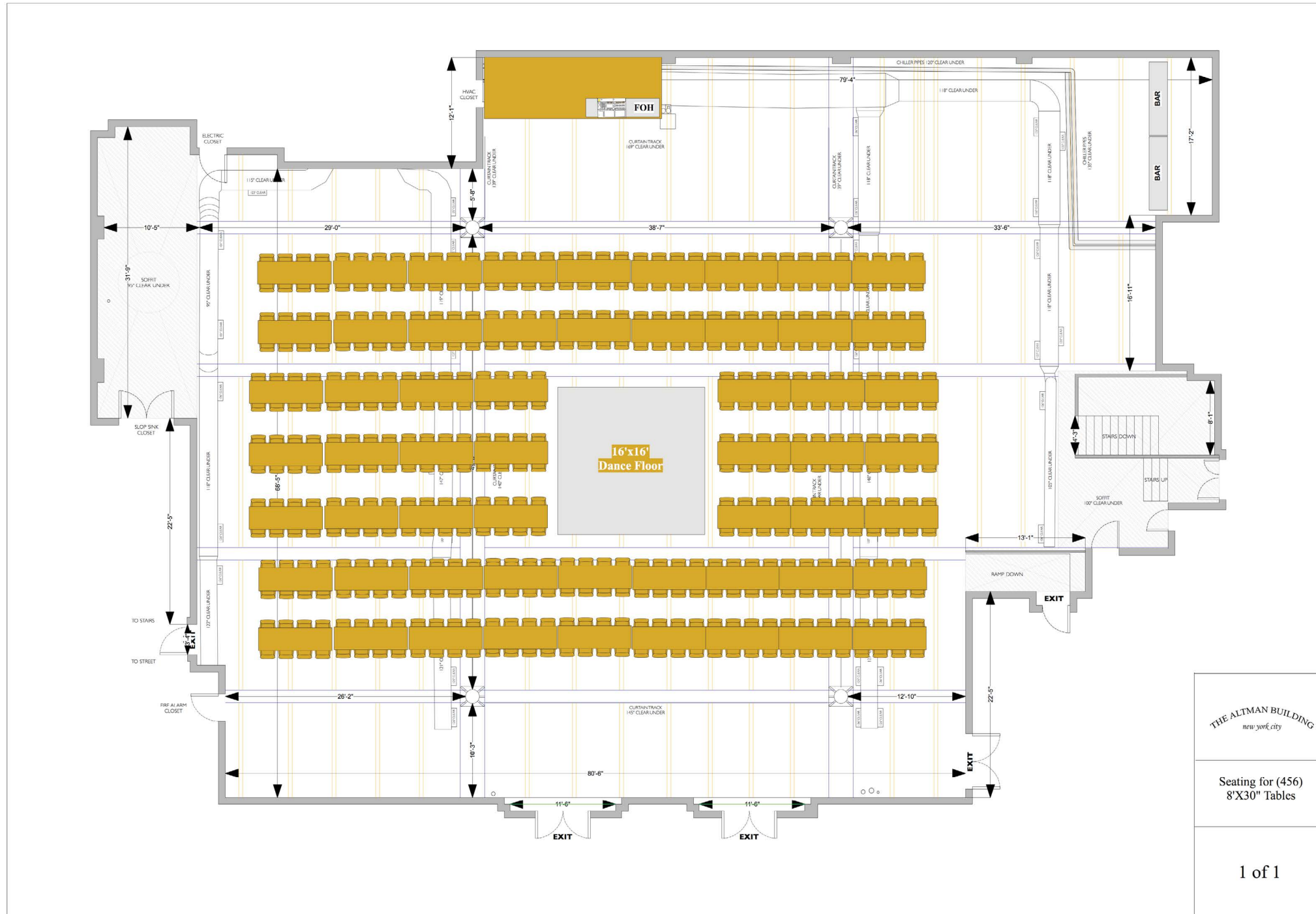

# THE ALTMAN BUILDING

New York

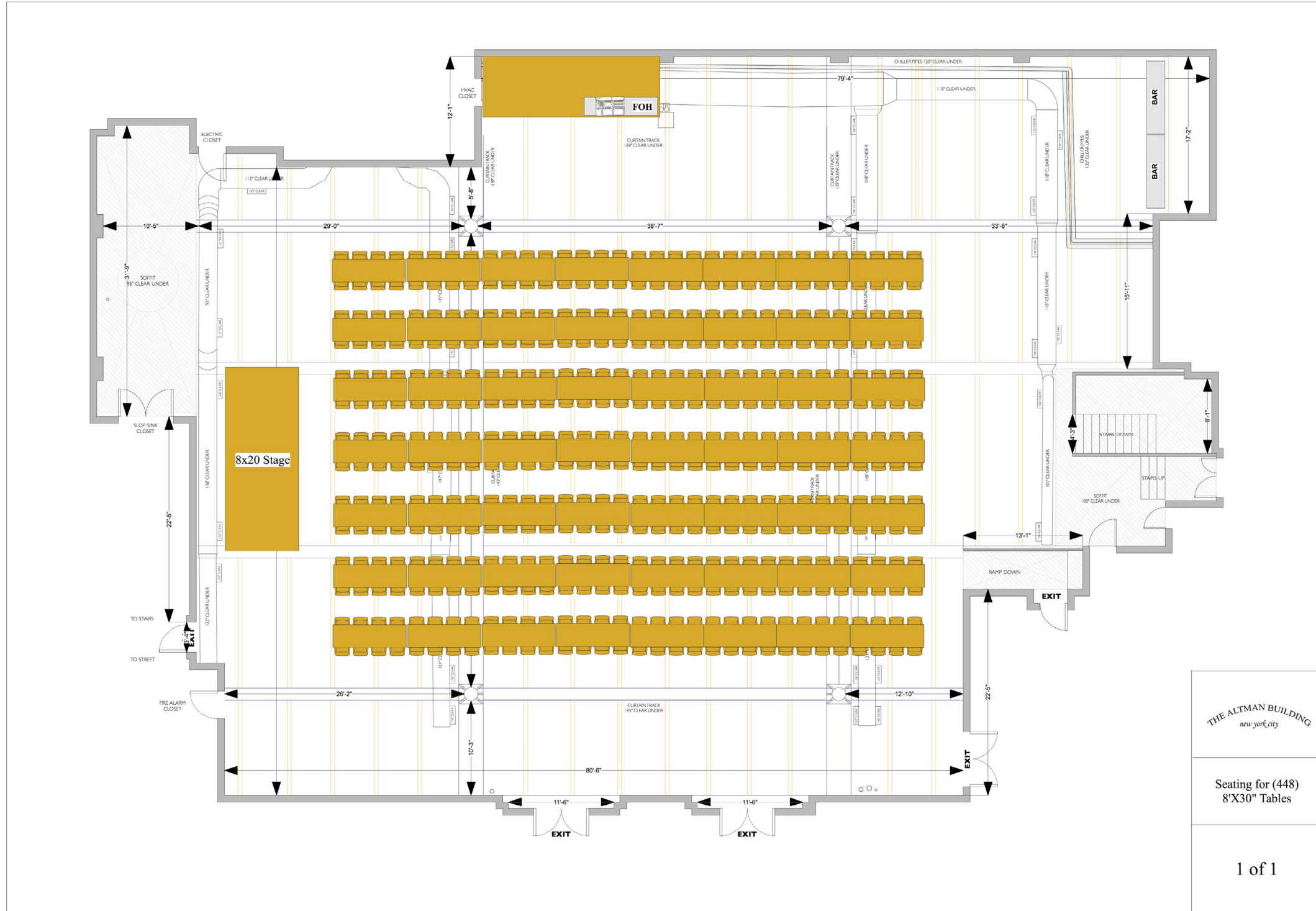

# THE ALTMAN BUILDING

New York

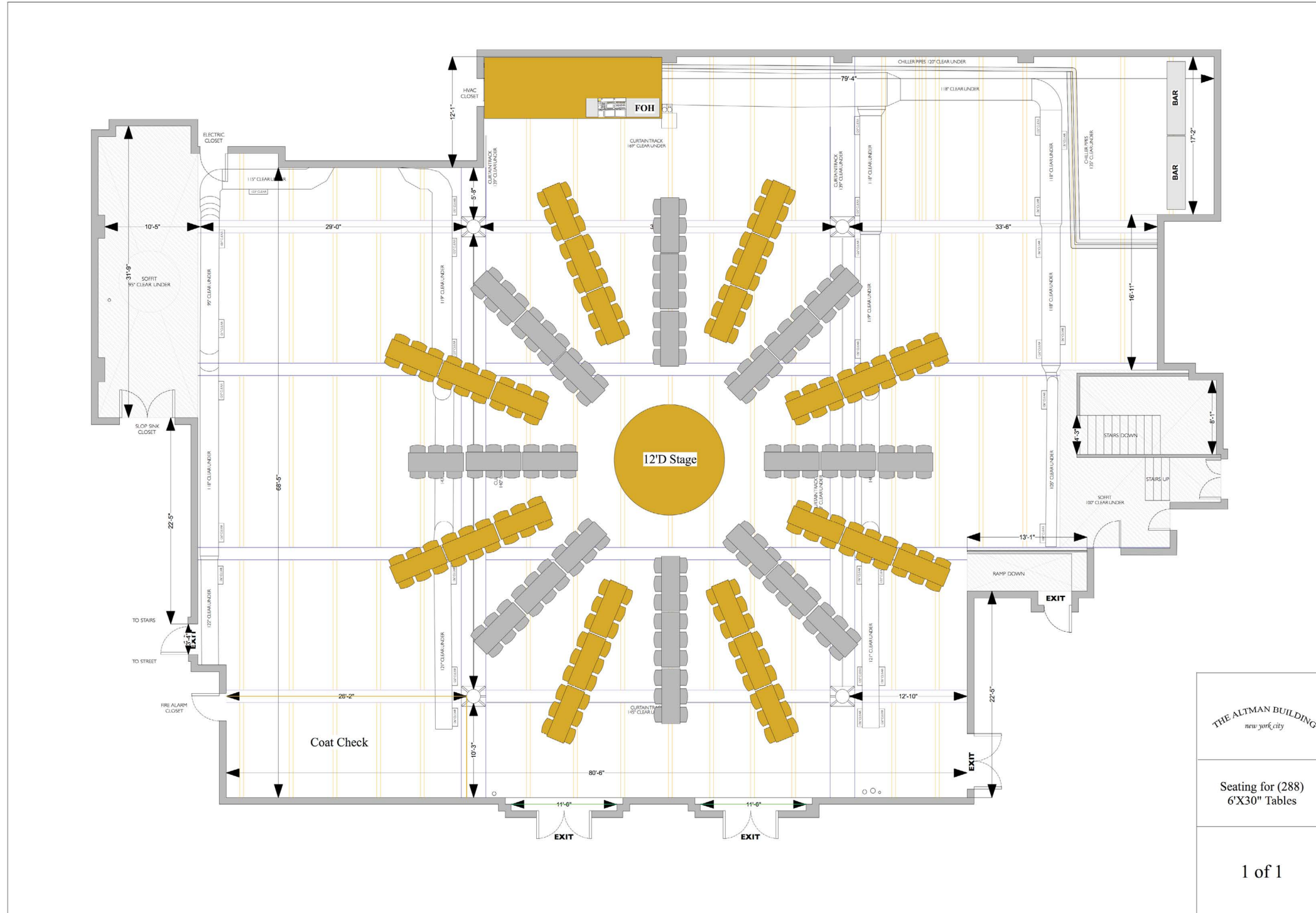

THE ALTMAN BUILDING  
new york city

Seating for (288)  
6'X30" Tables

# THE ALTMAN BUILDING

New York

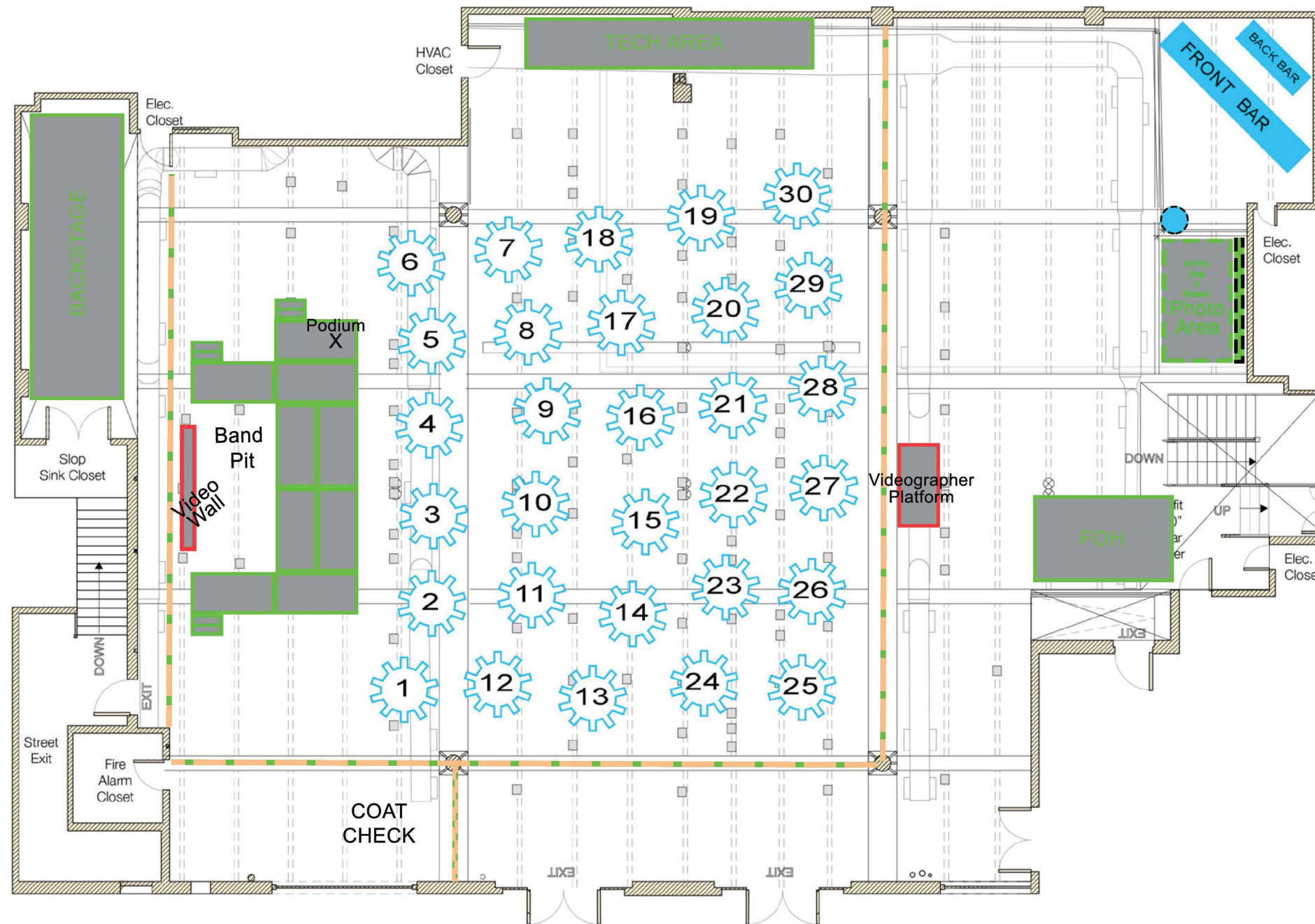

LEGEND  
 ■ Rigging Point

# THE ALTMAN BUILDING

New York

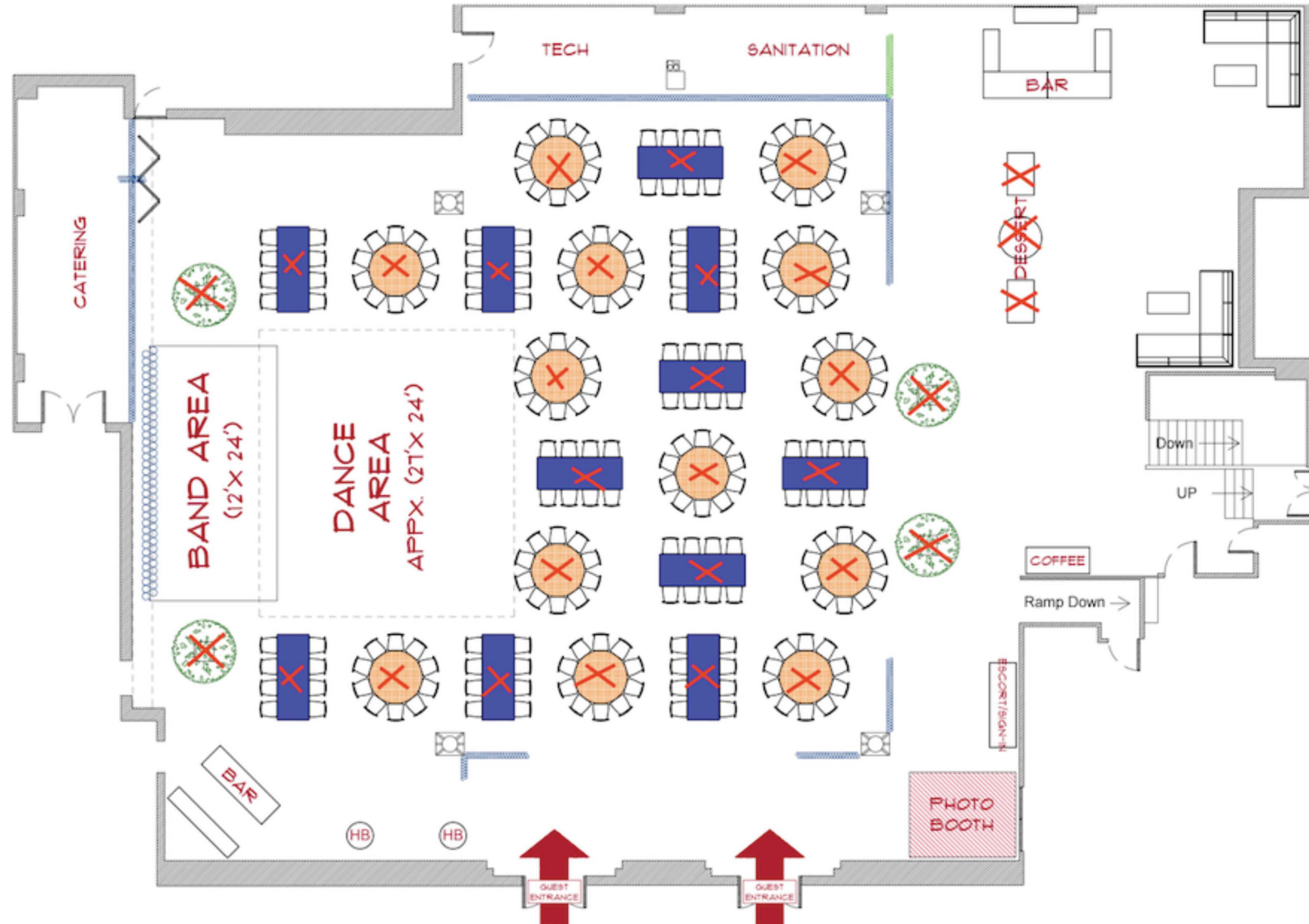

# THE ALTMAN BUILDING

New York

## Tasting Main Floor

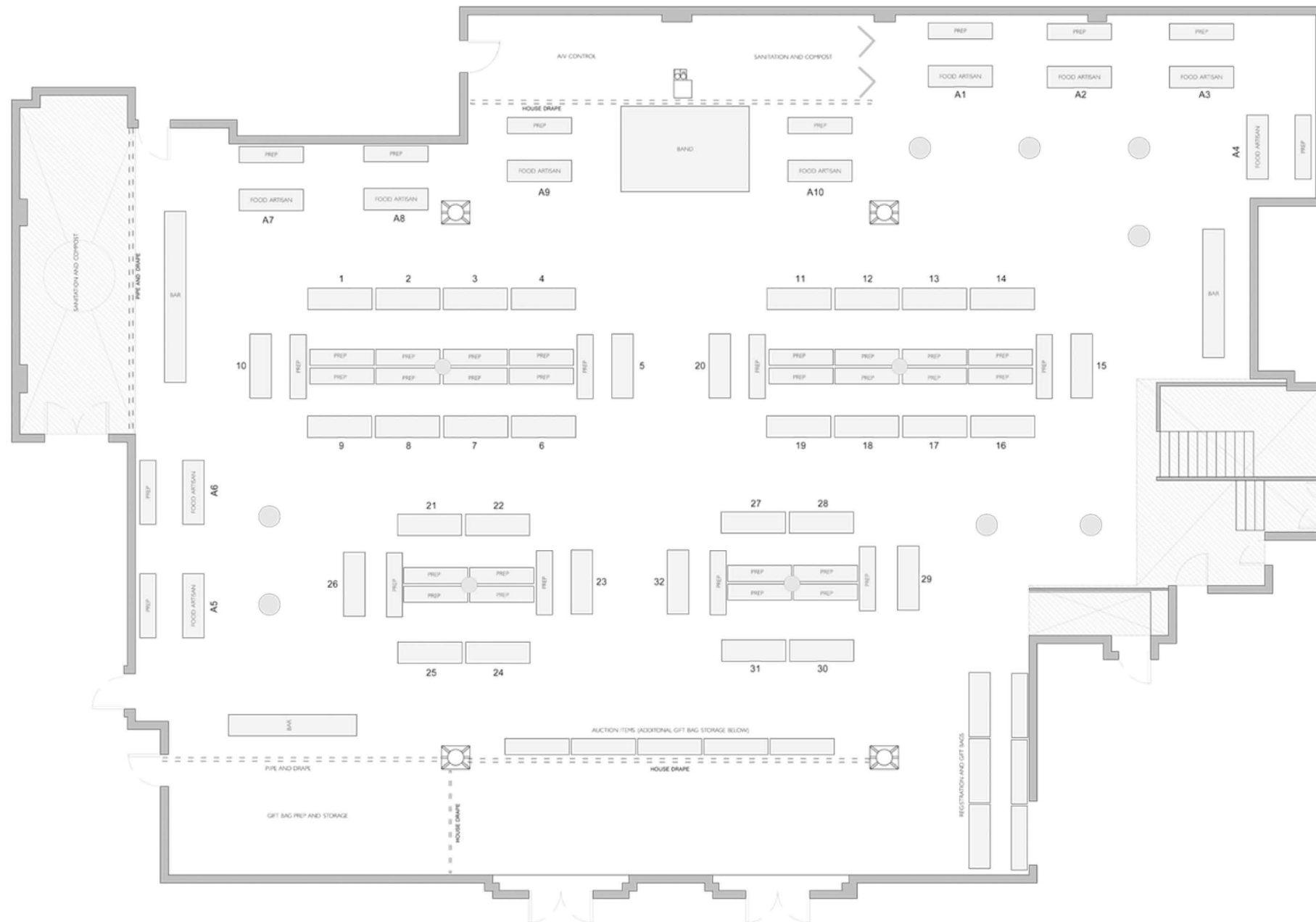

## Tradeshow w/ Standard Booths



# THE ALTMAN BUILDING

New York

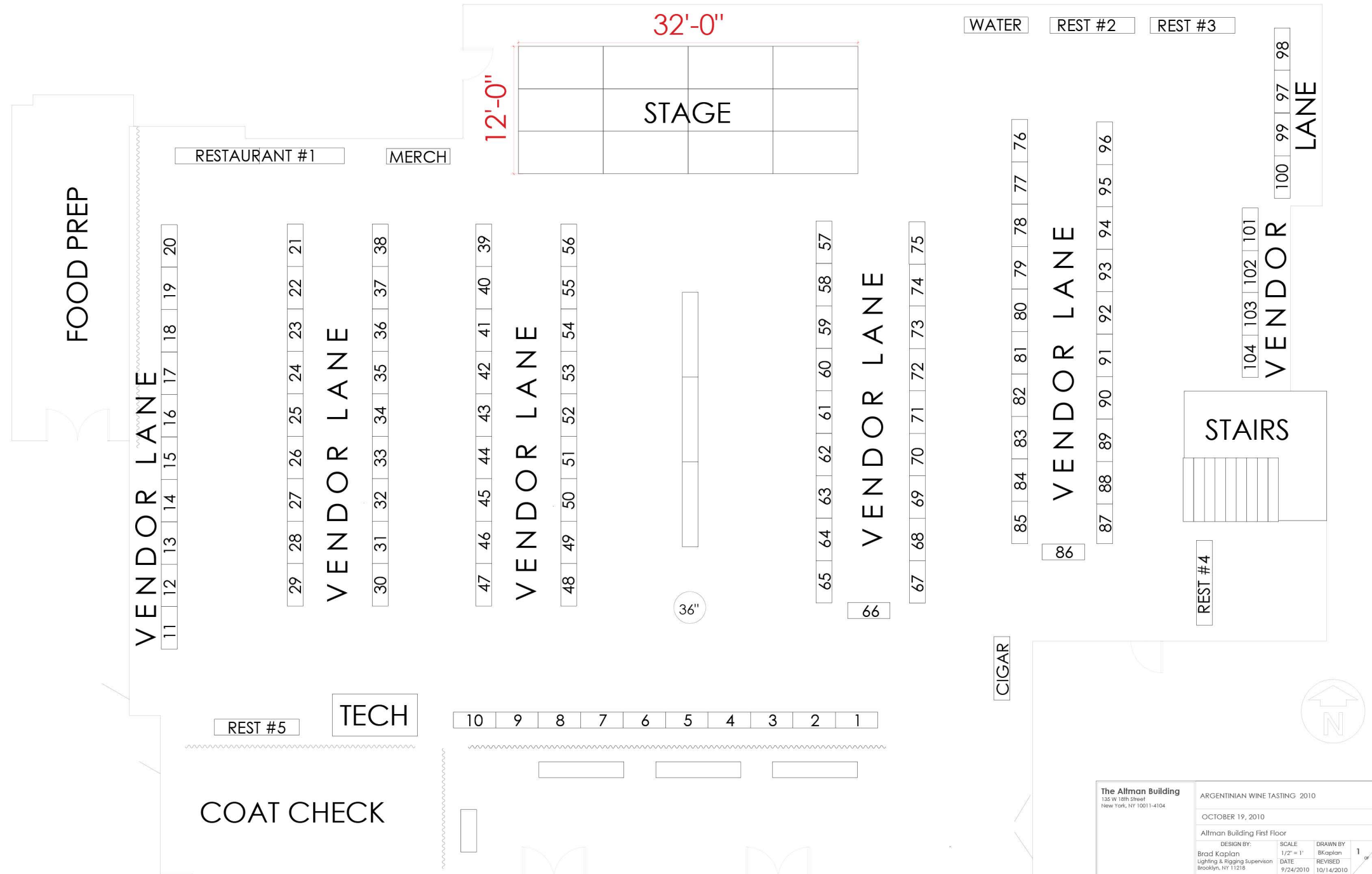

<b>The Allman Building</b> 135 W 18th Street New York, NY 10011-4104		ARGENTINIAN WINE TASTING 2010	
OCTOBER 19, 2010		Allman Building First Floor	
DESIGN BY: Brad Kaplan Lighting & Rigging Supervision Brooklyn, NY 11216	SCALE: 1/2" = 1'	DRAWN BY: BKaplan	1 of 1
DATE: 9/24/2010	REVISOR: 10/14/2010	REVISED:	1